

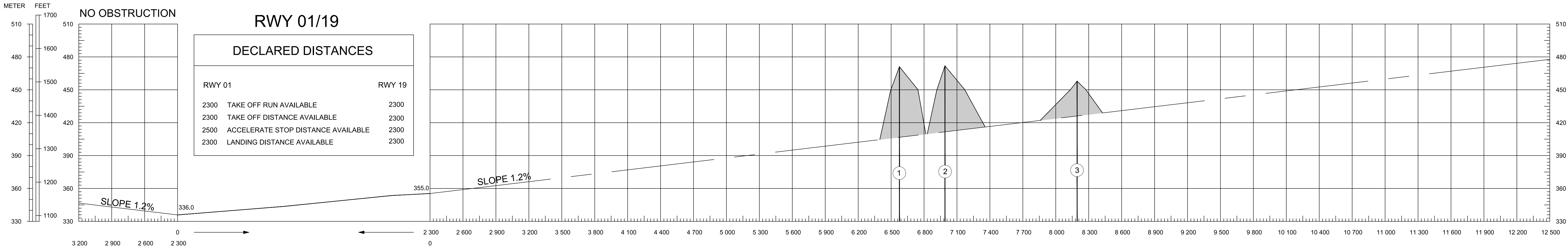

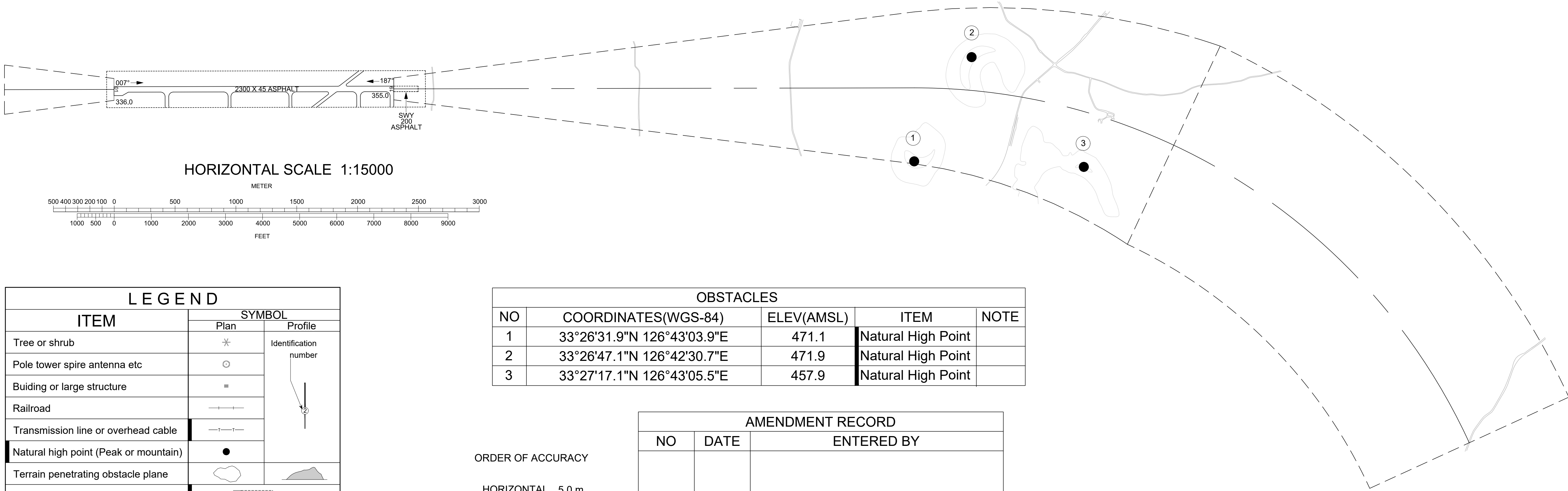

MAGNETIC VARIATION 7° W - 2020



VERTICAL SCALE 1:1500

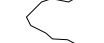
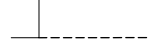

LEGEND		
ITEM	SYMBOL	
	Plan	Profile
Tree or shrub	✱	<div>Identification number</div> <div></div>
Pole tower spire antenna etc	○	
Buiding or large structure	■	
Railroad	—+—+—	
Transmission line or overhead cable	—+—+—	
Natural high point (Peak or mountain)	●	<div></div>
Terrain penetrating obstacle plane		
Stopway(SWY)	<div></div>	
Clearway(CWY)	<div></div>	

OBSTACLES				
NO	COORDINATES(WGS-84)	ELEV(AMSL)	ITEM	NOTE
1	33°26'31.9"N 126°43'03.9"E	471.1	Natural High Point	
2	33°26'47.1"N 126°42'30.7"E	471.9	Natural High Point	
3	33°27'17.1"N 126°43'05.5"E	457.9	Natural High Point	

ORDER OF ACCURACY

HORIZONTAL 5.0 m.  
VERTICAL 0.5 m.

AMENDMENT RECORD		
NO	DATE	ENTERED BY